



Pa Ag Odor Management Program Overview

- **Requires larger animal operations, and higher animal density operations, to develop and implement odor management plans when building new facilities.**
 - Larger operations are those defined as CAFOs
 - Higher density farms are those defined as CAOs
 - Odor Mgmt Plans developed by certified specialists
 - Odor Mgmt Plans approved by the Pa State Conservation Commission
 - The facilities addressed are new barns and new manure storages
- Establishes a statewide standard for odor management on animal farms throughout Pennsylvania



Who Falls Under This New Law?

CAOs and CAFOs building new facilities

- CAOs are defined in the Pa Nutrient Mgmt Act
 - More than 2,000 lbs of animals per acre
 - Approximately 1,000 of these farms in Pa
- CAFOs are defined by DEP
 - Greater than 1,000 Animal Units
 - Greater than 300 Animal Units and a CAO
 - EPA head numbers: 700 cows, 2500 pigs, 82,000 layers, etc
 - Approximately 350 of these farms in Pa
- **Only** CAOs and CAFOs building new facilities after February 26, 2009 are required to act under this law
 - But volunteers are encouraged to participate



What are they required to do?

Develop an Odor Management Plan

- Odor Management Plans are:
 - Written, site specific plan to minimize odor impacts from new facilities
 - Written by certified odor management specialists
 - Developed to address the new facilities to be built on the farm
- Plans must be submitted to the SCC
 - SCC is reviewing authority
 - SCC takes formal action to approve or disapprove the plan
- Timing of these odor management plans:
 - Approved Plan required prior to starting construction of facilities
 - Fully Implemented Plan required prior to using/ populating the facility



Odor Management Plans, a general overview

What is included in a plan?

1. An evaluation of potential odor impacts
2. Lists Odor BMPs necessary to address site with a higher odor conflict potential

What is the goal of a plan?

The goal is not to eliminate odors, but to minimize their impact on the community

Is funding available for planning?

Funding for plan development is authorized and may be available depending on state budget issues



More detail on what is in an Odor Mgmt Plan

- The plan includes a signed statement by the farmer agreeing to:
 - Implement & maintain Odor BMPs according to the schedule included in the plan
 - Keep required records relating to BMP implementation and maintenance activities
 - Allow the SCC to conduct inspections in accordance with bio-security protocols provided by the farmer
- The plan includes a signed statement by the planner attesting to the accuracy of the plan



More detail on what is in an Odor Mgmt Plan

The evaluation component of the plan

- Assesses potential impacts of offsite migration of odors
 - Scores facility as having Low, Medium, or High potential for odor conflicts
 - The tool developed to provide this evaluation is called the Pa Odor Site Index (PSU based tool)
- The topics addressed in this evaluation include:
 - Odor Sources
 - Site Land Uses
 - Surrounding Land Uses



More on the Pa Odor Site Index

More on the topics addressed in the OSI

- Odor Source Factors assess:
 - Animal Type & Number; Manure Storage Type; Animal History
- Site Land Use Factors assess:
 - The existence of any special ag land-use designations such as Ag Zoning, Ag Security Areas, and Farmland Preservation
- Surrounding Area Land Use Factors assess:
 - Existence of other animal operations in the evaluation area
 - Distance of facility to nearest property line
 - And the number of neighbors within the evaluation area



More on the Pa Odor Site Index

The OSI includes a map of the area

- A topographic map is used to document the various issues addressed in the Odor Site Index
- The map identifies the evaluation area for the plan
 - The evaluation area is sized based on the proposed AEU's for the operation
- The map identifies existing & proposed facilities on the farm
- The map also locates:
 - Homes and businesses
 - Neighboring Public Use Facilities
 - Other Livestock & Poultry Operations

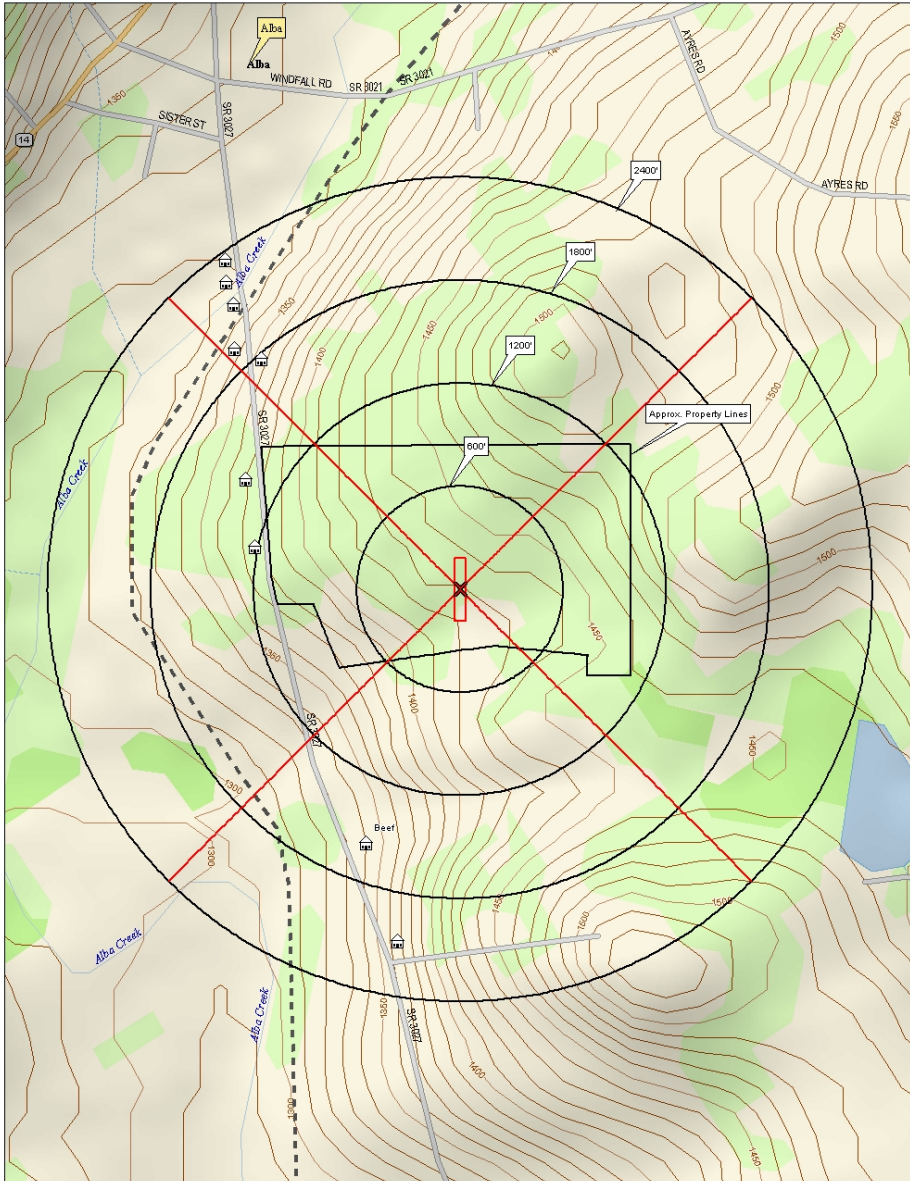

Example Map: 2,200 Swine Finishing (306 AEUs)

AEUs	Evaluation Distance
<50	1200'
50-199	1800'
<u>200-599</u>	<u>2400'</u>
600+	3000'



More detail on what is in an Odor Mgmt Plan

The Odor BMP section of the plan

- This section is where any required Odor BMPs will be listed
 - Odor BMPs are required if the Odor Site Index score is either Medium or High Potential
- Level I Odor BMPs (for Medium potential farms)
 - Basic, Management Oriented
- Level II Odor BMPs (for High potential farms)
 - Specialized, Non-Management Oriented



Selecting Odor BMPs for the plan

- Ag operator & planner choose Odor BMPs necessary to address the odor sources identified on site
 - Level 1 BMPs are established in the SCC's odor guidance
 - Level 2 BMPs are selected from available technologies
- Reference materials identifying Odor BMPs are on SCC website



What detail is required for the BMPs in the plan

Odor BMP criteria and schedules

- For Level I Odor BMPs:
 - The required detail for these Odor BMPs is included in the Odor Management Guidance document
 - Customize wording where necessary to make it farm specific
- For Level II Odor BMPs, include:
 - General Construction & Implementation Criteria
 - Implementation Timeframes for each Level 2 Odor BMP
 - Operation & Maintenance Procedures & Timeframes for each Level 2 Odor BMP



Documenting plan implementation

Plan describes required documentation

- The plan must list what information or observations will be documented by the Operator for each Odor BMP
 - The Operator records activities relating to required implementation and maintenance practices
 - The Operator records observations to demonstrate that the BMPs are working properly



For More Information:

SCC Odor Management Program webpage:

www.agriculture.state.pa.us/scc

Karl Dymond, SCC OM Program Coordinator

PDA Region 3 Office

PO Box C, Route 92 S

Tunkhannock, PA 18657-0318

(570) 836-2181 ext 3030

kdymond@state.pa.us